



	a	b	c	d	e	f	g	h	k	m	r
SIZE A	1000	1200	16	3	90	100DN	80	60	500	800	100
SIZE B	1500	1800	24	48	135	150DN	120	90	750	1200	150

Colour Legend

	Retroreflective white
	Black

Notes

1. This sign is to be used in conjunction with the application of a wide centre line treatment, radio tactile linemarking and lane narrowing developed and approved for use as detailed in TC1978_3.
2. Size A signs used for speeds of 80km/h and below. Size B signs to be used for speeds above 80 km/h.
3. For typical sign layout, refer to details on Page 5.
4. For image detail refer wide centre line image detail (1) on page 6.



**Queensland
Government**

INFORMATION SIGN WIDE CENTRE LINE TREATMENT "OVERTAKING NOT PERMITTED"

Department of Transport and Main Roads
Infrastructure Management & Delivery Division

APPROVED AS OFFICIAL TRAFFIC SIGN

Designed
TV 01/13

Checked
DJ 01/13

Scale
Not to Scale

PRINCIPAL ENGINEER
(Traffic Engineering)

24/11/15
Date

TC1979_1

Page 1 of 9

E F



	a	b	c	d	e	f	g	h	k	m	r
SIZE A	1000	1200	16	3	90	100DN	80	60	500	800	100
SIZE B	1500	1800	24	48	135	150DN	120	90	750	1200	150

Colour Legend

	Retroreflective white
	Black

Notes

1. This sign is to be used in conjunction with the application of a wide centre line treatment, radio tactile linemarking and lane narrowing developed and approved for use as detailed in TC1978_2.
2. Size A signs used for speeds of 80km/h and below. Size B signs to be used for speeds above 80 km/h.
3. For typical sign layout, refer to details on Page 5.
4. For image detail refer wide centre line image detail (2) on page 7.



**Queensland
Government**

Department of Transport and Main Roads
Infrastructure Management & Delivery Division

Designed
TV 01/13

Checked
DJ 01/13

Scale
Not to Scale

INFORMATION SIGN WIDE CENTRE LINE TREATMENT "OVERTAKING NOT PERMITTED"

APPROVED AS OFFICIAL TRAFFIC SIGN

PRINCIPAL ENGINEER
(Traffic Engineering)

24/11/15
Date

TC1979_2

Page 2 of 9

E F



	a	b	c	d	e	f	g	h	k	m	r
SIZE A	1000	1200	16	3	90	100DN	80	60	500	800	100
SIZE B	1500	1800	24	48	135	150DN	120	90	750	1200	150

Colour Legend

	Retroreflective white
	Black

Notes

1. This sign is to be used in conjunction with the application of a wide centre line treatment, radio tactile linemarking and lane narrowing developed and approved for use as detailed in TC1978_2.
2. Size A signs used for speeds of 80km/h and below. Size B signs to be used for speeds above 80 km/h.
3. For typical sign layout, refer to details on Page 5.
4. For image detail refer wide centre line image detail (3) on page 8.



**Queensland
Government**

Department of Transport and Main Roads
Infrastructure Management & Delivery Division

Designed
TV 01/13

Checked
DJ 01/13

Scale
Not to Scale

INFORMATION SIGN WIDE CENTRE LINE TREATMENT "OVERTAKING PERMITTED WHEN SAFE"

APPROVED AS OFFICIAL TRAFFIC SIGN

PRINCIPAL ENGINEER
(Traffic Engineering)

24/11/15
Date

TC1979_3

Page 3 of 9

☒ E ☐ F ☐ ☐ ☐



	a	b	c	d	e	f	g	h	k	m	r
SIZE A	1000	1200	16	30	90	100DN	80	60	500	800	100
SIZE B	1500	1800	24	48	135	150DN	120	90	750	1200	150

Colour Legend

	Retroreflective white
	Black

Notes

1. This sign is to be used in conjunction with the application of a wide centre line treatment, radio tactile linemarking and lane narrowing developed and approved for use as detailed in TC1978_1.
2. Size A signs used for speeds of 80km/h and below. Size B signs to be used for speeds above 80 km/h.
3. For typical sign layout, refer to details on Page 5.
4. For image detail refer wide centre line image detail (4) on page 9.



**Queensland
Government**

Department of Transport and Main Roads
Infrastructure Management & Delivery Division

Designed
TV 01/13

Checked
DJ 01/13

Scale
Not to Scale

INFORMATION SIGN WIDE CENTRE LINE TREATMENT "OVERTAKING PERMITTED WHEN SAFE"

APPROVED AS OFFICIAL TRAFFIC SIGN



PRINCIPAL ENGINEER
(Traffic Engineering)

24/11/15
Date

TC1979_4

Page 4 of 9

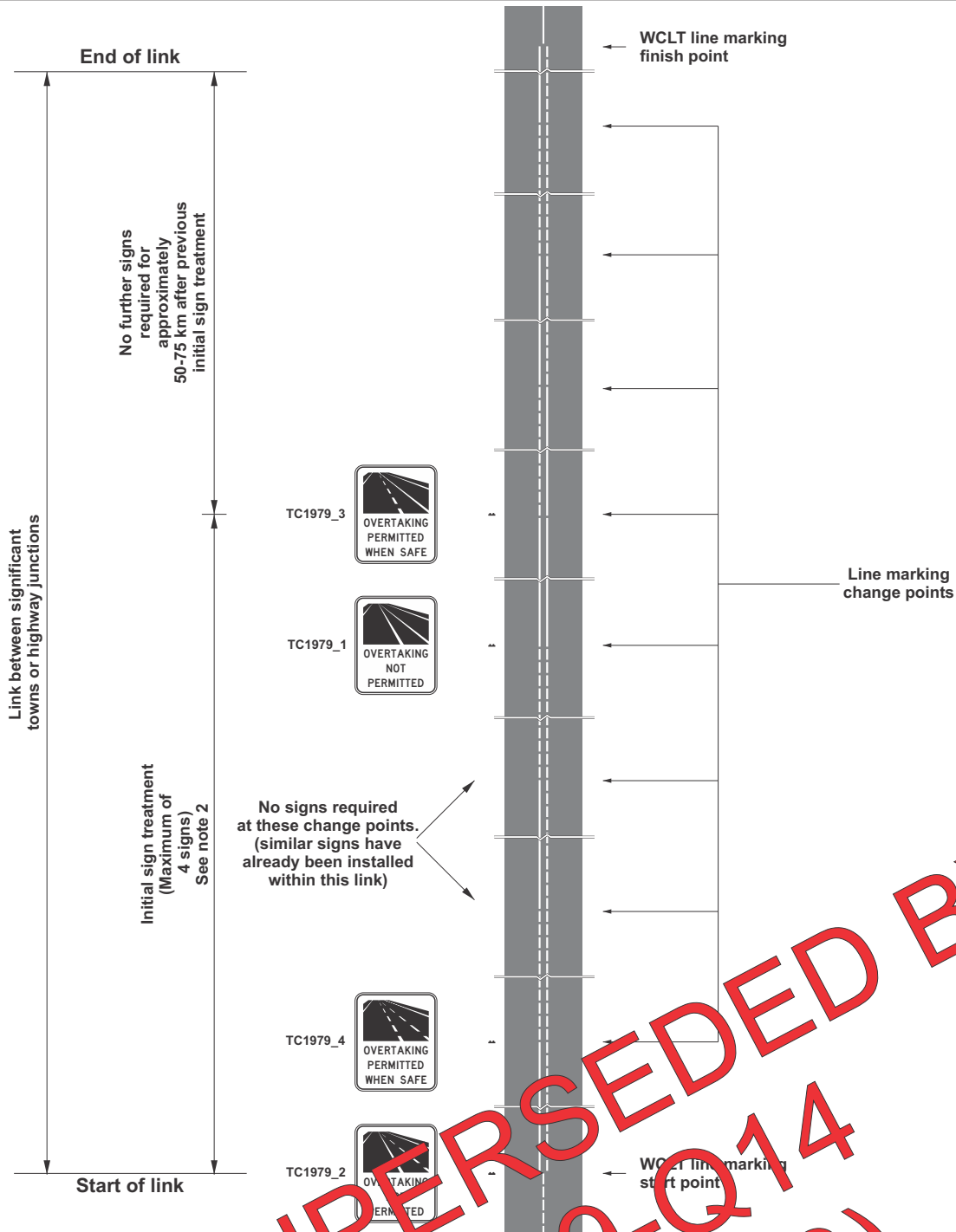
E	F			
---	---	--	--	--



Notes

1. For specific sign details refer to relevant pages 1 to 4.
2. A maximum of 4 signs to be installed at the start of and in each direction of a link that exists between significant towns or highway junctions. These signs are to be installed as part of the "initial sign treatment" with a sign change occurring only at each initial change of wide centre line treatment (WCLT) line marking.
3. After the initial sign treatment, further signs are generally not to be spaced any closer than 50–75 km apart (in many instances they will be greater than 100 km apart).



**Queensland
Government**

INFORMATION SIGN WIDE CENTRE LINE TREATMENT "TYPICAL SIGN LAYOUT"

Department of Transport and Main Roads
Infrastructure Management & Delivery Division

APPROVED AS OFFICIAL TRAFFIC SIGN

Designed
TV 01/13

Checked
DJ 01/13

Scale
Not to Scale

R. King
PRINCIPAL ENGINEER
(Traffic Engineering)

24/11/15
Date

TC1979

Page 5 of 9

E F

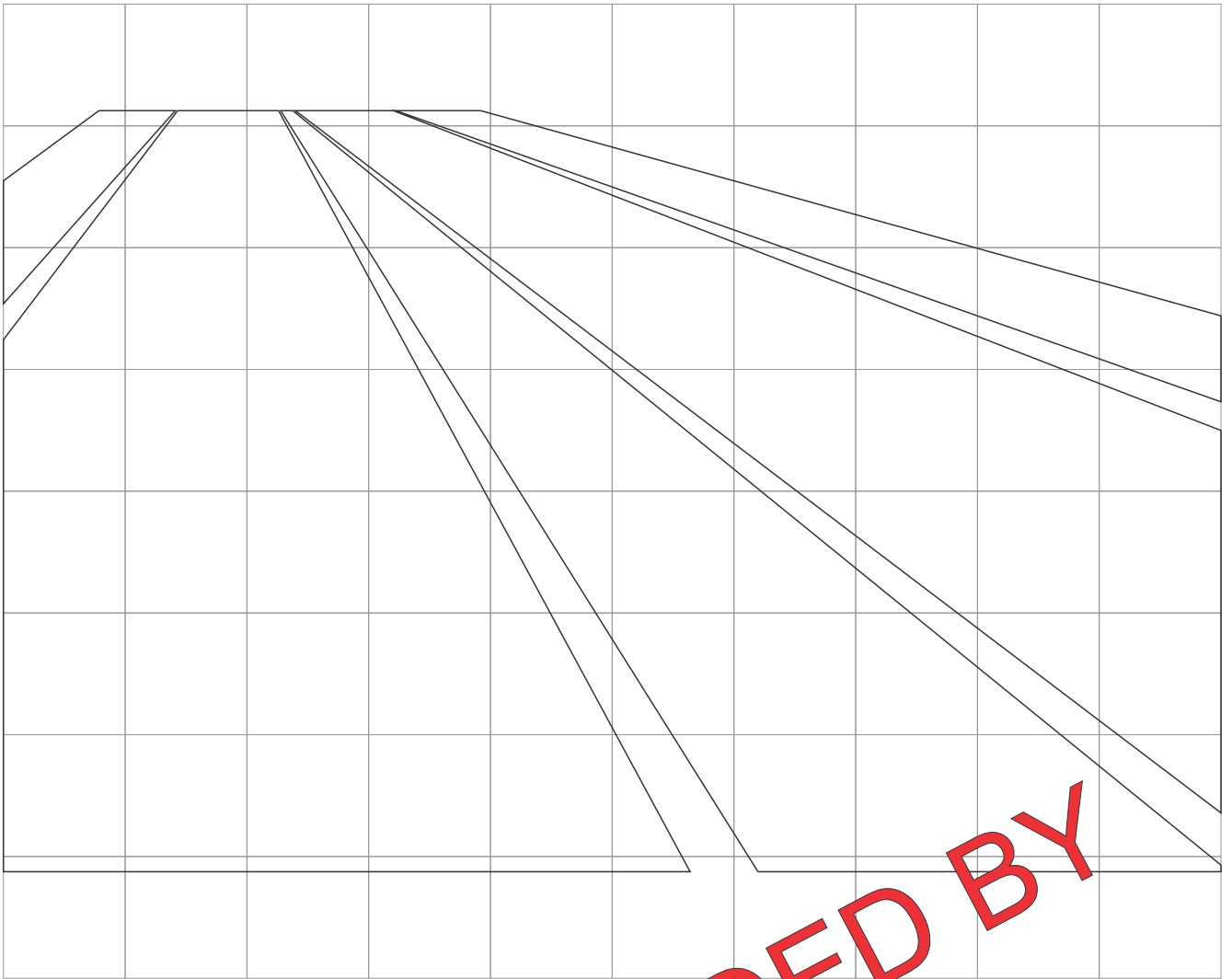

SUPERSEDED BY
G9-Q14
(05/23)

Notes

1. For sign details see page 1



**Queensland
Government**

Department of Transport and Main Roads
Infrastructure Management & Delivery Division

Designed
TV 01/13

Checked
DJ 01/13

Scale
Not to Scale

**INFORMATION SIGN
WIDE CENTRE LINE IMAGE DETAIL(1)**

APPROVED AS OFFICIAL TRAFFIC SIGN

R King
PRINCIPAL ENGINEER
 (Traffic Engineering)

18/11/15
 Date

TC1979

Page 6 of 9

E F

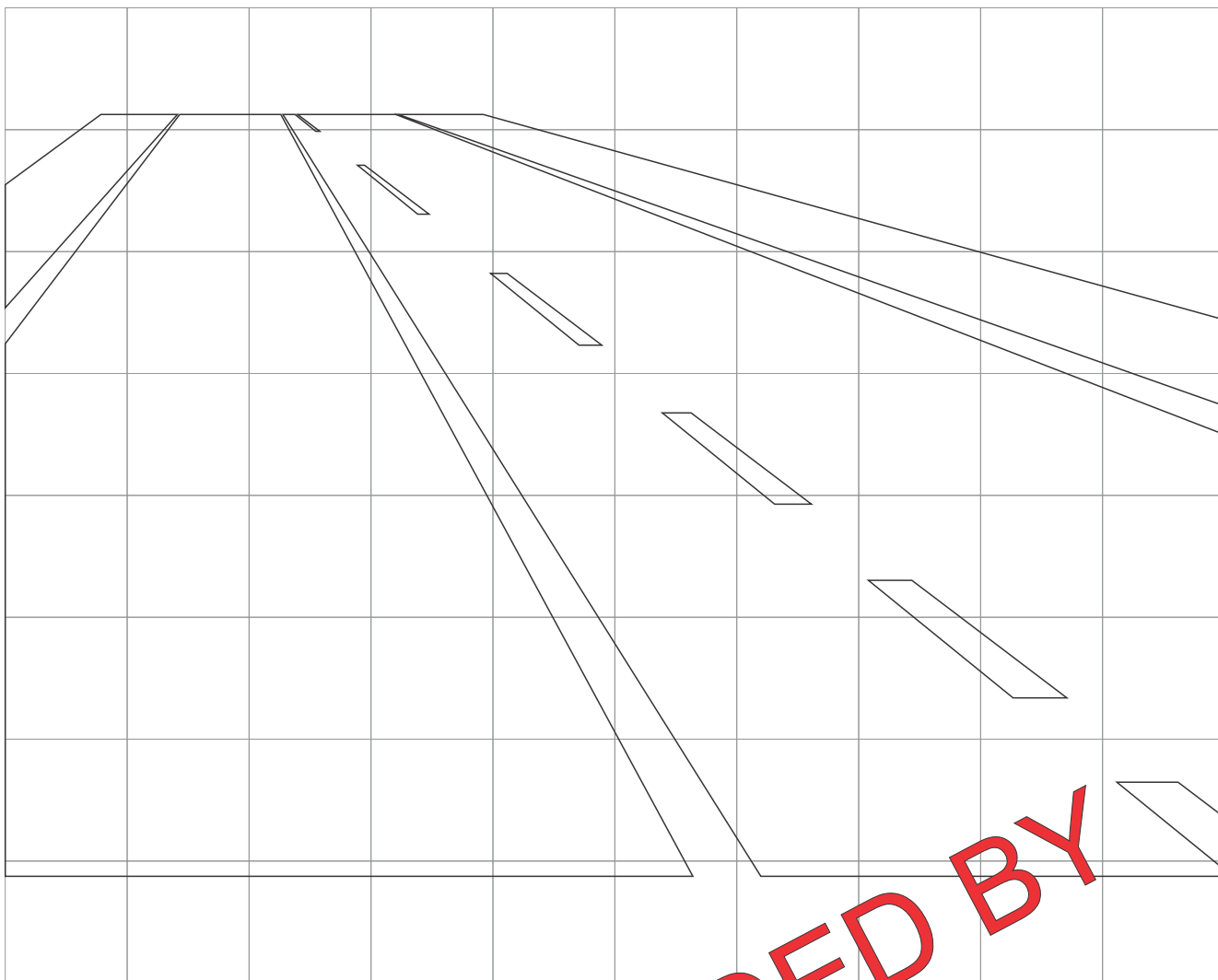

SUPERSEDED BY
G9-Q14
(05/23)

Notes

1. For sign details see page 2



**Queensland
Government**

Department of Transport and Main Roads
Infrastructure Management & Delivery Division

Designed
TV 01/13

Checked
DJ 01/13

Scale
Not to Scale

**INFORMATION SIGN
WIDE CENTRE LINE IMAGE DETAIL(2)**

APPROVED AS OFFICIAL TRAFFIC SIGN

R King
PRINCIPAL ENGINEER
 (Traffic Engineering)

18/11/15
Date

TC1979

Page 7 of 9

E	F			
---	---	--	--	--

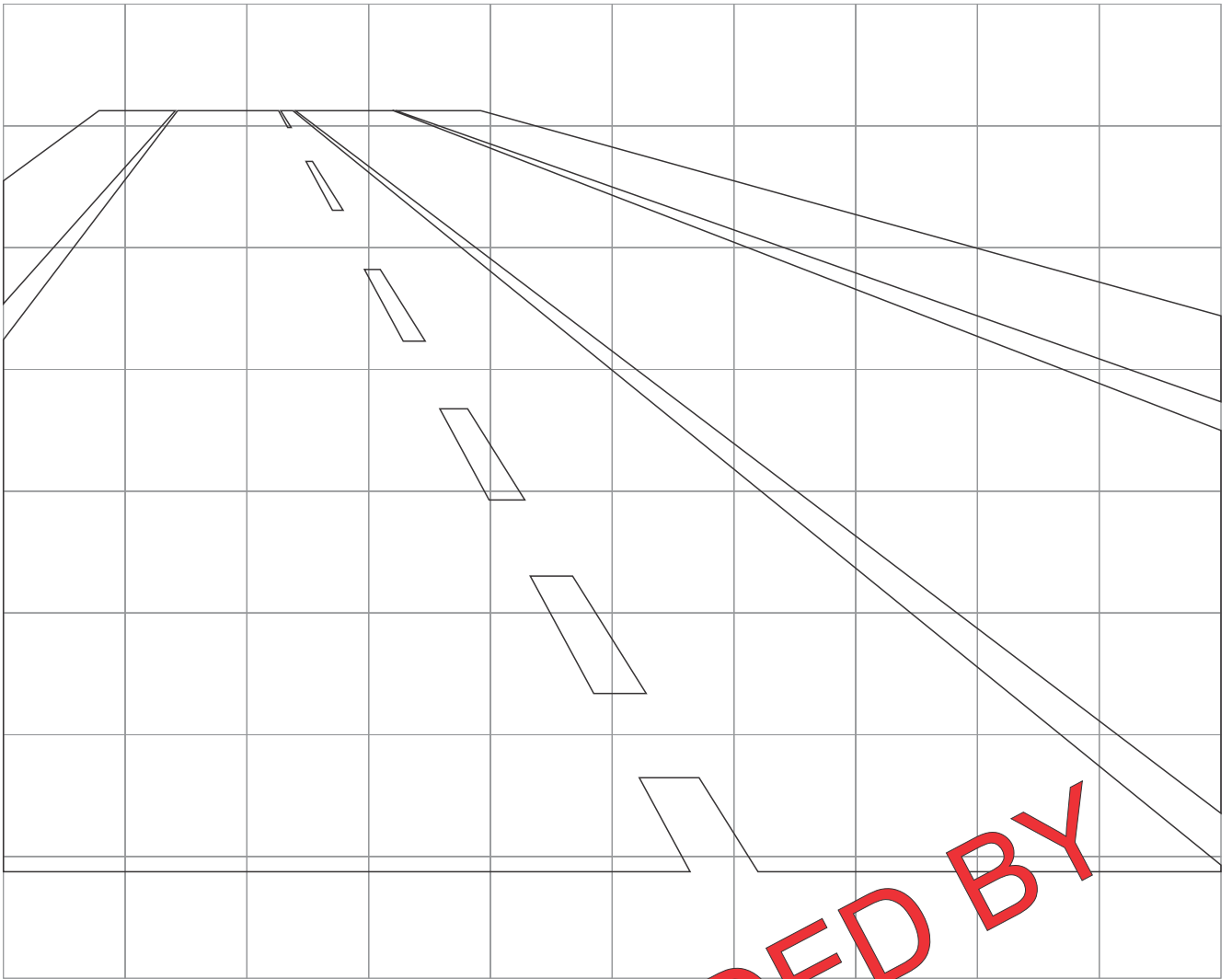

SUPERSEDED BY
G9-Q14
(05/23)

Note:
 1. For sign details see page 3



**Queensland
Government**

**INFORMATION SIGN
WIDE CENTRE LINE IMAGE DETAIL(3)**

Department of Transport and Main Roads
Infrastructure Management & Delivery Division

APPROVED AS OFFICIAL TRAFFIC SIGN

Designed
TV 01/13

Checked
DJ 01/13

Scale
Not to Scale

R King
PRINCIPAL ENGINEER
 (Traffic Engineering)

18/11/15
 Date

TC1979

Page 8 of 9

E	F			
---	---	--	--	--

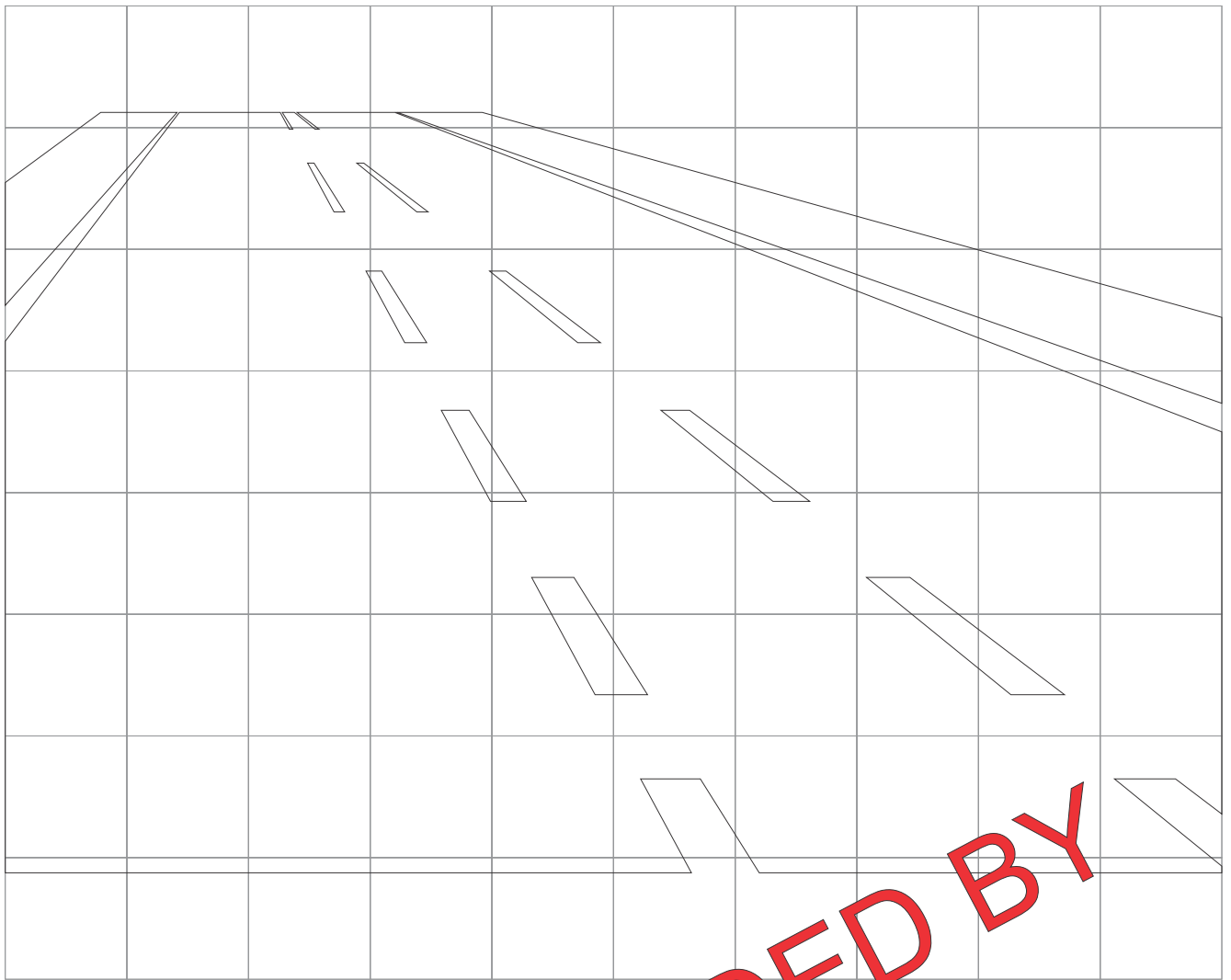

SUPERSEDED BY
G9-Q14
(05/23)

Note:
 1. For sign details see page 4



**Queensland
Government**

**INFORMATION SIGN
WIDE CENTRE LINE IMAGE DETAIL(4)**

Department of Transport and Main Roads
Infrastructure Management & Delivery Division

APPROVED AS OFFICIAL TRAFFIC SIGN

Designed
TV 01/13

Checked
DJ 01/13

Scale
Not to Scale

R. King
PRINCIPAL ENGINEER
 (Traffic Engineering)

18/11/15
 Date

TC1979

Page 9 of 9

E F