



	a	a ₁	b	b ₁	c	d	e	f	g	h	r	r ₁
SIZE A	450	600	900	1050	45	75CM	50	440	35	180DN	50	125
SIZE B	600	800	1200	1400	60	100CM	65	586	467	240DN	75	175
SIZE C	900	1200	1800	2100	90	150CM	100	880	700	360DN	100	250
SIZE D	1200	1600	2400	2800	120	200CM	134	1172	964	480DN	150	350

Colour Legend

	Retroreflective white
	Retroreflective red
	Retroreflective orange
	Black

Notes

1. This sign may be used in advance of a bridge that requires speed limiting due to damage that exist on the bridge. For guidance for use, refer to the Manual of Uniform Traffic Control (MUTCD) Part 4: Speed Controls Supplement Part 4 - "Speed Limits at Bridges".
2. * Insert appropriate speed limit. e.g. 80.
3. Refer to page 2 for sign set out details.



**Queensland
Government**

Department of Transport and Main Roads
Infrastructure Management & Delivery Division

Designed
TV 03/16

Checked
DJ 03/16

Scale
Not to Scale

REGULATORY SIGN SPEED LIMIT "BRIDGE DAMAGE CONTROL"

APPROVED AS OFFICIAL TRAFFIC SIGN

ACTING PRINCIPAL ENGINEER
(Traffic Engineering)

23/03/16
Date

TC2224

Page 1 of 2

A ☐ ☐ ☐ ☐

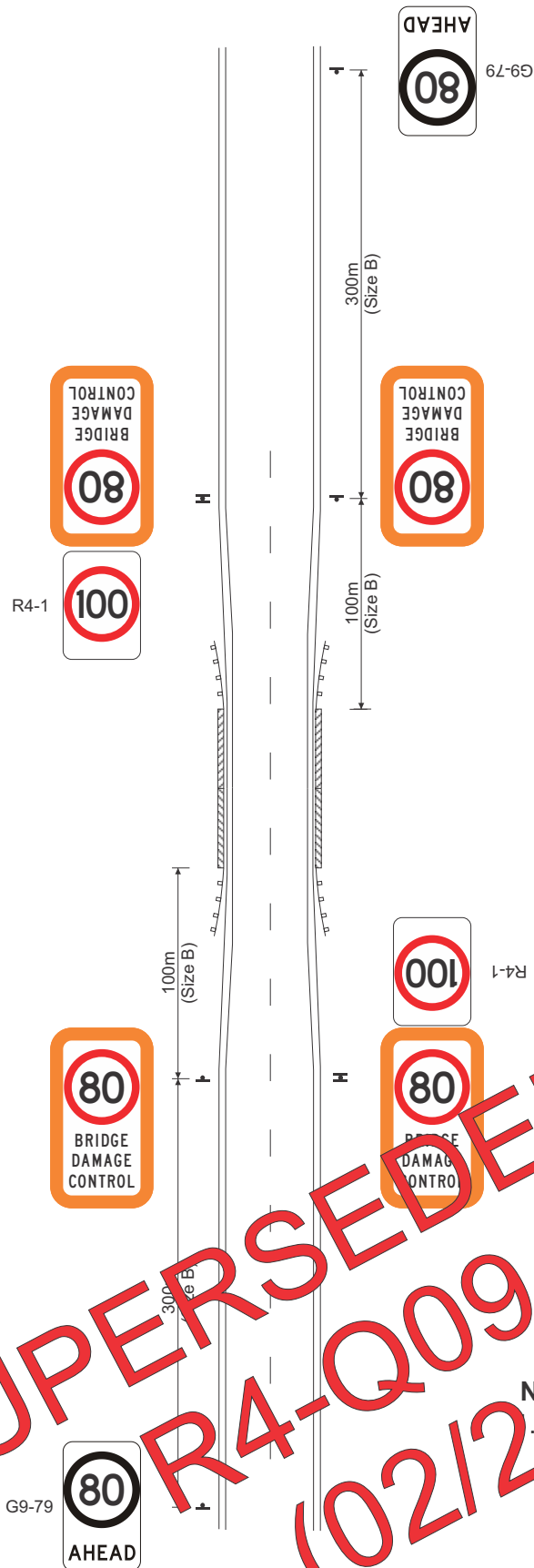

Notes

For BRIDGE DAMAGE CONTROL sign details refer to page 1.



Queensland
Government

DAMAGED BRIDGE SPEED LIMIT TYPICAL SIGN LAYOUT

Department of Transport and Main Roads
Infrastructure Management & Delivery Division

APPROVED AS OFFICIAL TRAFFIC SIGN

Designed
TV 03/16

Checked
DJ 03/16

Scale
Not to Scale

Sany...
ACTING PRINCIPAL ENGINEER
(Traffic Engineering)

23/03/16
Date

TC2224

Page 2 of 2

A ☐ ☐ ☐ ☐ ☐