

TC1475\_1



TC1475\_2



TC1475\_3

Colour Legend



Black



Retroreflective white

Note: For working examples refer to page 2.



Queensland  
Government

MULTI-MESSAGE SIGN PLATE  
"ROAD CLOSED"

Department of Transport and Main Roads  
Infrastructure Management & Delivery Division

APPROVED AS OFFICIAL TRAFFIC SIGN

TC1475

Page 1 of 2

Designed  
RH 04/18

Checked  
DJ 04/18

Scale  
Not to Scale

PRINCIPAL ENGINEER  
(Traffic Engineering)

04/04/18  
Date

F

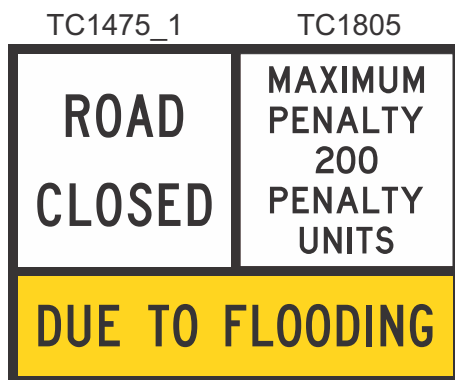

TC1869

Example A

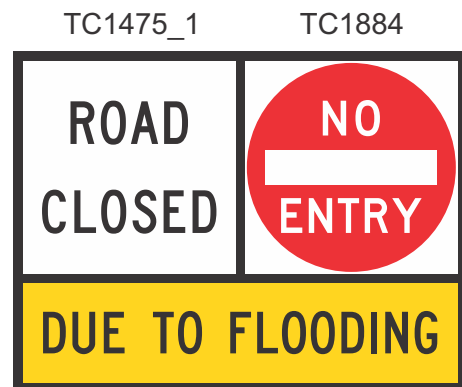

TC1869

Example B

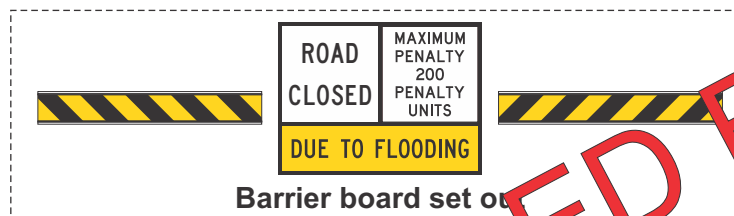

### Colour Legend

	Black
	Retroreflective white
	Retroreflective yellow
	Retroreflective red

### Notes:

1. Example A is enforceable through S46 of the Transport Infrastructure Act 1994.
2. Example B is not enforceable through the S46 Transport Infrastructure Act 1994, but are enforceable through road rules.
3. Road Closed signs are to be used in conjunction with barrier boards installed across the road with the bars aligned to point towards the sign. See set out detail above.



**Queensland  
Government**

Department of Transport and Main Roads  
Infrastructure Management & Delivery Division

Designed  
RH 04/18

Checked  
DJ 04/18

Scale  
Not to Scale

## MULTI-MESSAGE SIGN PLATE

“NO ENTRY / ROAD CLOSED” EXAMPLES

APPROVED AS OFFICIAL TRAFFIC SIGN

PRINCIPAL ENGINEER  
(Traffic Engineering)

04/04/18  
Date

**TC1475**

Page 2 of 2

F