

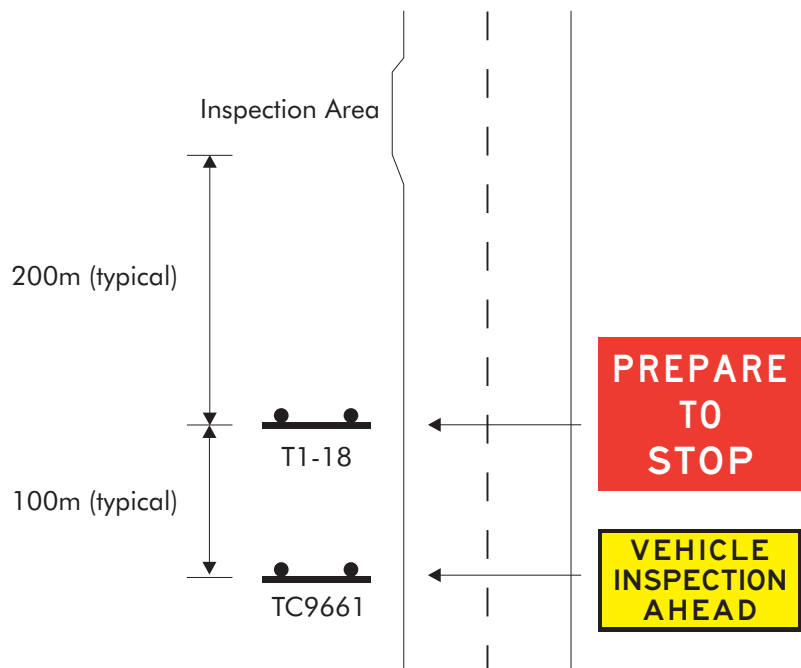

This sign should be used in conjunction with T1-18 (PREPARE TO STOP) - see application detail



#### Colour Legend

- Black
- Retroreflective yellow

**Typical Application Detail (100 km/h speed environment)**  
Distance can be halved in 60 km/h speed environments



## TEMPORARY SIGN "VEHICLE INSPECTION AHEAD"

Transport Technology Division  
Traffic Engineering Section

ORIGINAL APPROVED AS OFFICIAL TRAFFIC SIGN

Designed  
JD 6/94

Checked  
MIC 6/94

Scale  
1:10 approx.

*[Signature]*  
MANAGER  
(Traffic Engineering & Operations)

8/6/94  
Date

TC9661

A ☐ ☐ ☐ ☐ ☐